

Product range

**Series 4.1**

Pitch 14 mm (0.6")

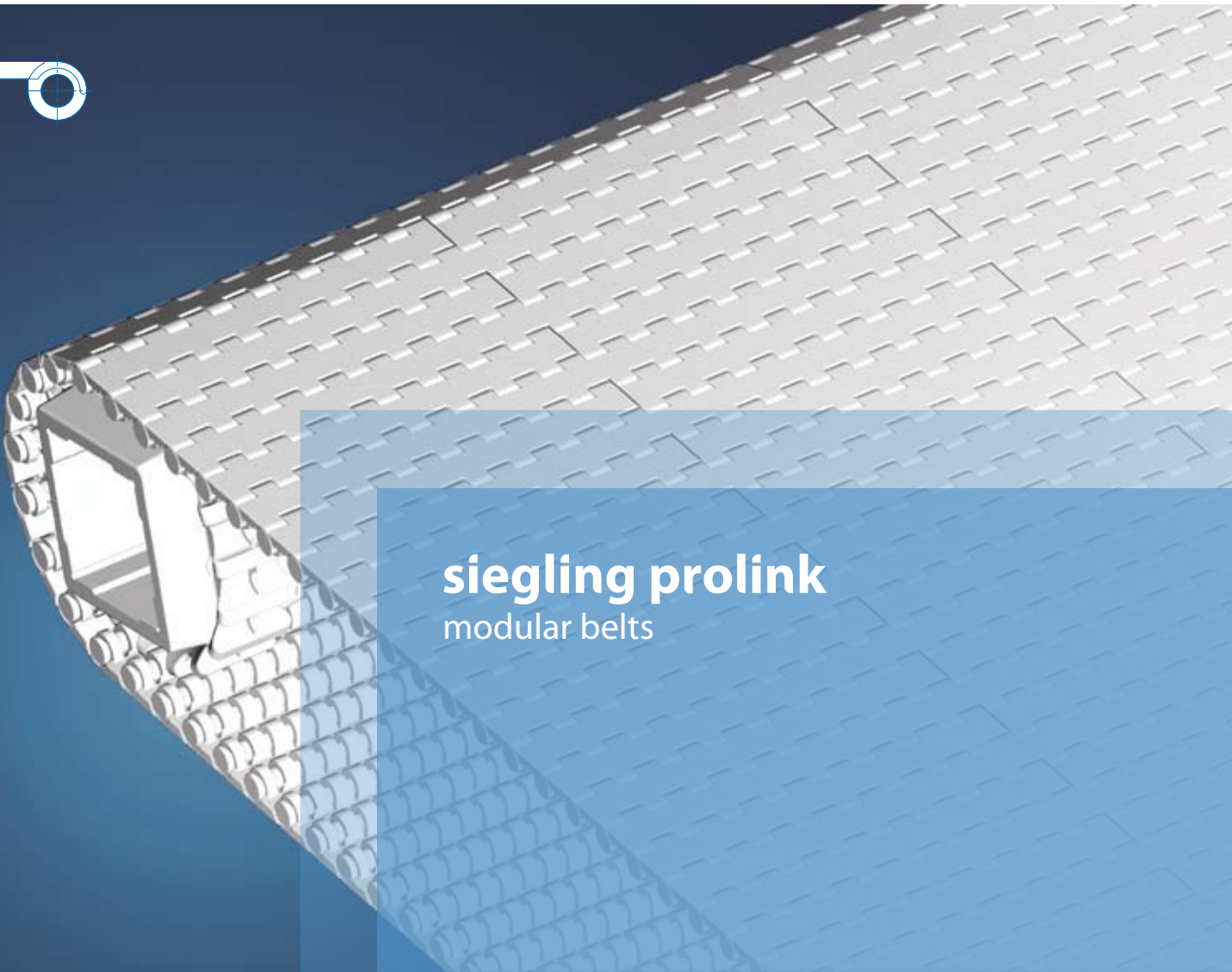

**siegling prolink**  
modular belts

Siegling Prolink

# Series 4.1

Linear modules,  
pitch 14 mm (0.6")

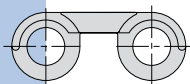

Scale 1:1

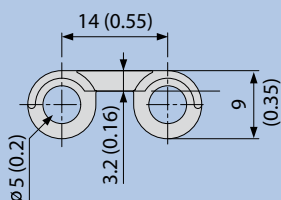
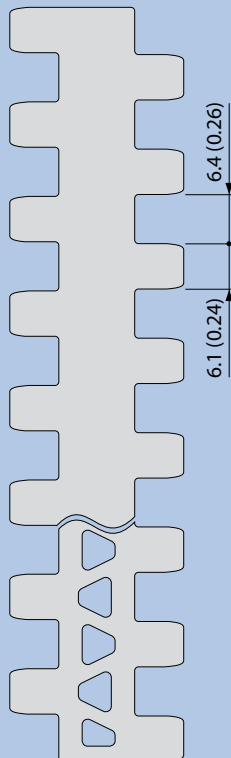

Key dimensions in mm and inches ("), scale 1:2.  
All imperial dimensions (inches) are rounded off.

## Belt types

### S4.1-0 FLT

Closed, smooth surface

### S4.1-21 FLT

Open, smooth surface

### Design characteristics

- Light to medium-duty belt for both food and industrial applications.
- Small pitch allows tight product transfers, including nose bars.
- Excellent for draining, drying, cooling and accumulation applications.
- Used for handling small food items and containers requiring tight transfers.

### Pitch

14 mm (0.6")

### Belt width min.

25 mm (1")

### Width increments

In increments of 12.5 mm (0.5").

### Hinge pins

Made of plastic (PE, PP, PBT).

### Certification

For certification see fold-out page.



Materials	Colours	Open area [%]	Allowable belt pull [N/mm (lb/ft)]	Weight [kg/m <sup>2</sup> (lb/ft <sup>2</sup> )]
PE	WT	0	3 (206)	5.1 (1.0)
PP	WT/BL	0	5 (343)	4.6 (0.9)
POM	WT/BL	0	10 (685)	7.11 (1.5)
PE	WT	21	3 (206)	4.5 (0.9)
PP	WT/BL	21	5 (343)	4.09 (0.8)
POM	WT/BL	21	10 (685)	6.45 (1.3)

## Sprockets

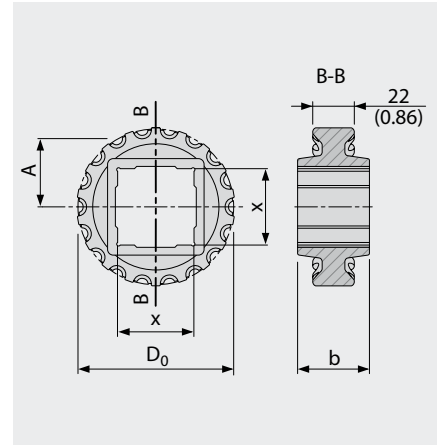

Sprocket size	Z10	Z12	Z18	Z26	Z35
b [mm]	25	25	38	38	38
["]	(1.0)	(1.0)	(1.5)	(1.5)	(1.5)
D <sub>0</sub> [mm]	45	55	81	116	156
["]	(1.8)	(2.2)	(3.2)	(4.6)	(6.1)
A [mm]	18	23	35	53	73
["]	(0.7)	(0.9)	(1.4)	(2.1)	(2.9)

x [mm] (sprocket bore metric)	Z10	Z12	Z18	Z26	Z35
20	●/■				
25		■	■		●
30					●
40			■	■	■
60				■	■

x ["] (sprocket bore imperial)	Z10	Z12	Z18	Z26	Z35
3/4	●				
1		■			
1.5			■	■	■
2.5				■	■

- Sprocket bore round
- Sprocket bore square

D<sub>0</sub> Pitch circle diameter  
 A Distance centre of sprocket bore/  
 top edge support

The fold-out page at the back will explain all abbreviations used and the type key.

# Type designation, key

## Type designation\*

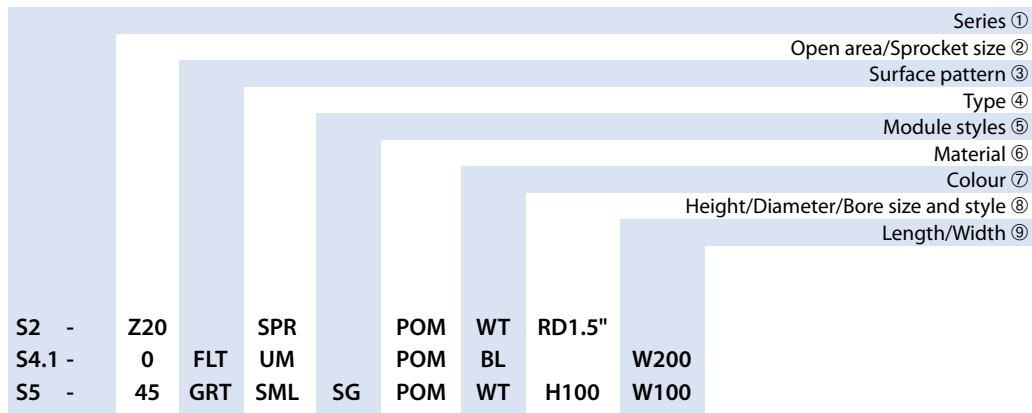

## Key

<b>① Series</b> S1 S2 S3 S4.1 S5 S6.1 S7 S8 S9	<b>④ Type</b> <b>CM</b> = Centre module <b>SML</b> = Side module, left <b>SMR</b> = Side module, right <b>SMU</b> = Side module, universal/both sides <b>UM</b> = Universal module <b>PMC</b> = Profile module centre <b>PMU</b> = Profile module universal <b>PMU lxx</b> = Profile module universal with indent xx = indent in mm <b>CLP</b> = Clip <b>RI</b> = Rubber insert <b>SG</b> = Module with sideguard <b>PIN</b> = Coupling rod <b>FPL</b> = Finger plate <b>SPR</b> = Sprocket <b>RTR</b> = Retaining ring <b>TPL</b> = Turning panel, left <b>TPR</b> = Turning panel, right	<b>⑥ Material</b> <b>PA 6.6</b> = Polyamide <b>PA 6.6-HT</b> = Polyamide high temperature <b>PBT</b> = Polybutylenterephthalate <b>PE</b> = Polyethylene <b>PE-HA</b> = PE with HACCP batch <b>PE-MD</b> = PE metal detectable <b>POM</b> = Polyoxymethylene (Polyacetal) <b>POM-CR</b> = POM cut resistant <b>POM-CRHA</b> = POM cut resistant with HACCP batch <b>POM-HA</b> = POM with HACCP batch <b>POM-HC</b> = POM highly conductive <b>POM-MD</b> = POM metal detectable <b>POM-UV</b> = POM UV-resistant <b>PP</b> = Polypropylene <b>PP-HA</b> = PP with HACCP batch <b>PP-HC</b> = PP highly conductive <b>PXX</b> = Self-extinguishing material <b>PXX-HC</b> = Self-extinguishing highly conductive material <b>PPA</b> = Polyphthalamide PPA <b>POM-PE</b> = POM side modules + PE centre modules <b>POM-PP</b> = POM side modules + PP centre modules <b>SER</b> = Self-extinguishing rubber <b>SS</b> = Stainless steel	<b>⑦ Colour**</b> <b>AT</b> = Anthracite <b>BL</b> = Blue <b>BG</b> = Beige <b>BK</b> = Black <b>DB</b> = Dark blue <b>GN</b> = Green <b>LB</b> = Light blue <b>LG</b> = Light grey <b>OR</b> = Orange <b>RE</b> = Red <b>TR</b> = Transparent <b>WT</b> = White <b>YL</b> = Yellow
<b>② Open area/Sprocket size</b> Percentage open area Format: xx E.g. 20 = 20 % For sprockets: number of teeth Format: "Z"xx E.g. Z12 = 12 teeth	<b>⑤ Module styles</b> <b>BT</b> = Bearing tap <b>G</b> = Guided <b>SG</b> = Side guard <b>ST</b> = Strong (S5) <b>DR</b> = Double row sprocket <b>SP</b> = Split sprocket <b>F1, F2,</b> = Collapse factor <b>F3 ...</b> modules	<b>⑧ Height/Diameter/Bore size and style</b> Height in mm Format: Hxxx Pin diameter in mm Format: Dxxx Bore size: SQ (= square) or RD (= round) either in mm or inches Format: SQxxMM or RDxx"	<b>⑨ Length/Width</b> Pins Length in mm Format: Lxxx Module width in mm Format: Wxxx

\* Not every product requires all characteristics (within the designation).  
If there is an irrelevant characteristic, this category will be ignored and replaced by the following one.

\*\* Please refer to the table of types for each series' standard colours.  
A number of other colours are available on request.  
Colours can vary from the original due to the print, production processes or material used.

# Temperature ranges/HACCP types/materials

## Temperature ranges in °C

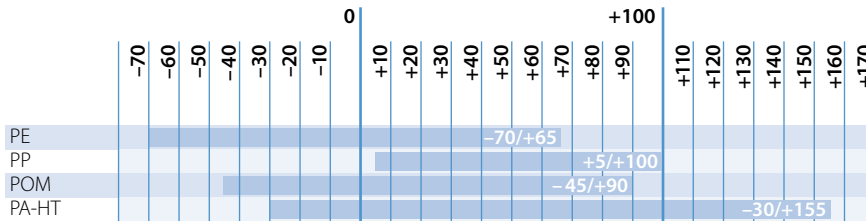

## Temperature ranges in °F

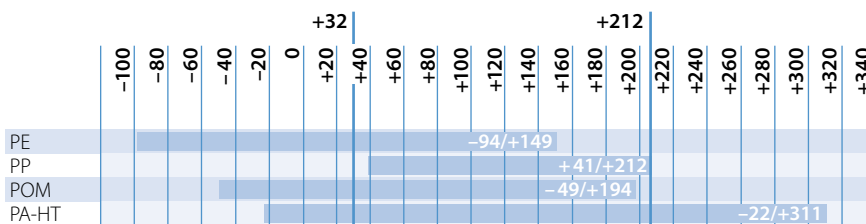

## HACCP types/certification

Siegling Prolink modular belts made of PE, PP and POM comply with FDA regulations and EU-directive 1935/2004, as well as the associated directives on the materials used and migration levels.

Due to a variety of hygiene-friendly properties, some series support your HACCP concept. These properties include:

### Excellent resistance to hydrolysis

- resistant to hot water, cleaning agents and disinfectants

### Good release properties

- beneficial when manufacturing adhesive foodstuffs (minimal product wastage)
- product residue is easy to remove
- easy-to-clean hinge design

### Blue a strong colour contrast

- soiling is easier to identify
- suitable for usage in optical sorters
- reduces light reflection, making working conditions better

## Materials

### PE (Polyethylene)

- very good chemical resistance to acids and alkalis
- very good release properties due to low surface tension
- good friction and abrasion behaviour
- extremely tough
- low specific weight

### PP (Polypropylene)

- standard material for normal conveying applications
- quite strong and stiff
- good dynamic capacity
- highly resistant to acids, alkalis, salts, alcohols
- low specific weight
- no risk of stress cracks forming

### POM (Polyoxymethylene/Polyacetal)

- very dimensionally stable
- very strong and stiff
- high chemical resistance to organic solvents
- lower drag
- very durable material
- hard, incision-resistant surface

### POM-CR (POM cut resistant)

- highly resistant to impact and incision
- easy to clean
- minimal ridge formation
- low risk of material delamination

### POM-HC (POM highly conductive)

- highly conductive material
- surface resistivity < 10<sup>6</sup> Ω (according to specification)
- very strong and stiff
- very good friction and abrasion properties

### POM-MD (POM metal detectable)

- material easily detected in metal detectors
- very strong and stiff
- very good tribological properties (friction and abrasion levels)

### PA 6.6-HT (Polyamide high temperature)

- material reinforced with fibre glass
- very high short-term temperature resistance up to 180 °C (356 °F)
- absorbs little water in humid environments
- very stiff
- durable

### PXX-HC (self-extinguishing highly conductive material)

- flame retardant in line with DIN EN 13501 (B<sub>fl</sub>-s1) and DIN 4102 (B1)
- surface resistivity < 10<sup>6</sup> Ω
- specially for use in the automotive industry

### PBT (Polybutylenterephthalate)

- good wear resistance
- very good abrasive resistance
- good strength and stiffness

### PXX (self-extinguishing material)

- quite strong and stiff
- good dynamic capacity
- highly resistant to acids, alkalis, salts, alcohols

## Siegling – total belting solutions

Committed staff, quality-orientated organisation and production processes ensure the constantly high standards of our products and services. The Forbo Siegling Quality Management System is certified in accordance with DIN EN ISO 9001.

In addition to product quality, environmental protection is an important corporate goal. Early on we also introduced an environmental management system, certified in accordance with ISO 14001.

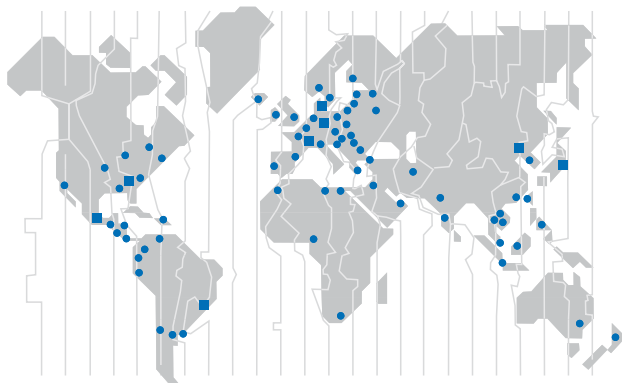

### Forbo Siegling Service – anytime, anywhere

In the company group, Forbo Siegling employs more than 1800 people worldwide. Our production facilities are located in eight countries; you can find companies and agencies with stock and workshops in more than 50 countries. Forbo Siegling service centres provide qualified assistance at more than 300 locations throughout the world.